

Aldreds
Estate Agents



1 Campion Avenue

Gorleston, Great Yarmouth, NR31 7NB

£230,000



1 Campion Avenue

Gorleston, Great Yarmouth, NR31 7NB

A very well presented 3 bedroom end terraced house with a detached double garage/workshop. This property is offered for sale with no onward chain.

Entrance Porch

7'6" x 2'11" (2.29m x 0.89m)

UPVC entrance door with double glazed panel. Tiled floor. UPVC double glazed windows to front and side.

Entrance Hall

10'9" x 6'5" (3.28m x 1.96m)

Entrance door with double glazed panels. Night storage heater. Fitted shelves below stairs with a secret door to a built-in storage cupboard. Staircase with turned wood balustrade to first floor landing. Decorative cornicing.

Lounge

13'5" x 10'10" plus recess (4.09m x 3.30m plus recess)

Night storage heater. Feature fireplace with a tiled hearth. Cable television point. Telephone point. Smooth plaster ceiling. Decorative cornicing. UPVC double glazed window to front aspect.

Kitchen

11'1" max x 9'9" (3.38m max x 2.97m)

Worktops with cupboards and drawers below. One and a half bowl single drainer sink with mixer tap. Tiled splashbacks. Matching wall cupboards and open display/storage shelves. Built-in wine rack. Electric cooker with induction hob and an extractor above. Pull-out bin/recycling drawer. Utility space below worktop with plumbing for washing machine. Utility spaces below worktops with refrigerator and freezer. Built-in shelved pantry cupboard. UPVC double glazed window to rear aspect. UPVC door with double glazed panel to side.

Dining Area

10'1" x 8'8" (3.07m x 2.64m)

Night storage heater. Low fitted storage cupboards and matching wall mounted glass fronted display cabinets. Built-in shelved storage cupboard. Built-in airing cupboard and hot water cylinder with immersion heater. Smooth plaster ceiling. UPVC double glazed window to the rear garden.

First Floor

Landing

Night storage heater. Decorative cornicing. Loft access hatch with a loft ladder. UPVC double glazed window to side.





Bedroom 1
 10'11" x 10'9" plus recesses (3.33m x 3.28m plus recesses)
 UPVC double glazed window to front aspect.

Bedroom 2
 11'11" x 10'0" plus recesses (3.63m x 3.05m plus recesses)
 Built-in wardrobe with shelf and hanging rail. Smooth plaster ceiling. Decorative cornicing. UPVC double glazed window to rear aspect.

Bedroom 3
 9'1" x 7'9" max (2.77m x 2.36m max)
 Over stairs bulkhead. Smooth plaster ceiling. Decorative cornicing. UPVC double glazed window to front aspect.

Bathroom
 5'5" x 5'4" (1.65m x 1.63m)
 Fully tiled walls and a coloured suite comprising panelled bath with mixer tap and shower attachment. Pedestal wash basin. UPVC double glazed window to rear.

Separate WC
 5'5" x 2'5" (1.65m x 0.74m)
 White WC. Decorative cornicing. UPVC double glazed window to side.

Outside
 The front garden is laid to lawn either side of a driveway leading to a detached double garage with up-and-over door, lighting and power, window and door to side. The rear garden is laid to lawn.

Tenure
 Freehold.

Services
 Mains water, electricity and drainage are connected.

Council Tax
 Great Yarmouth Borough Council - Band B

Location
 Gorleston on Sea is a coastal town 2 miles from Great Yarmouth centre and has a varied selection of local shops * Golf Course * Modern District hospital * Schools for all ages * Library * Regular bus services to the main shopping areas and a sandy beach.

what3words
 ///meals.calculating.durations

Ref: G18413/11/25



Floor Plan

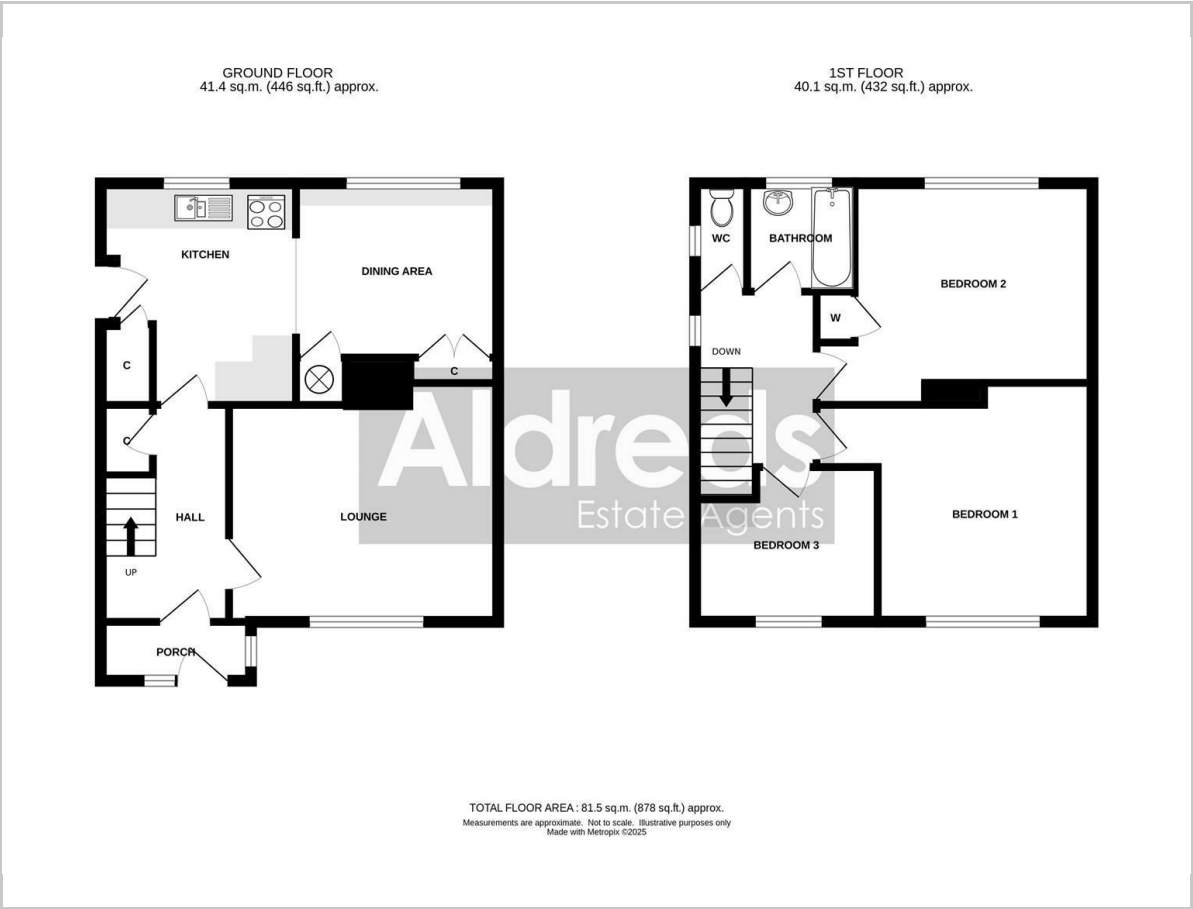

Area Map

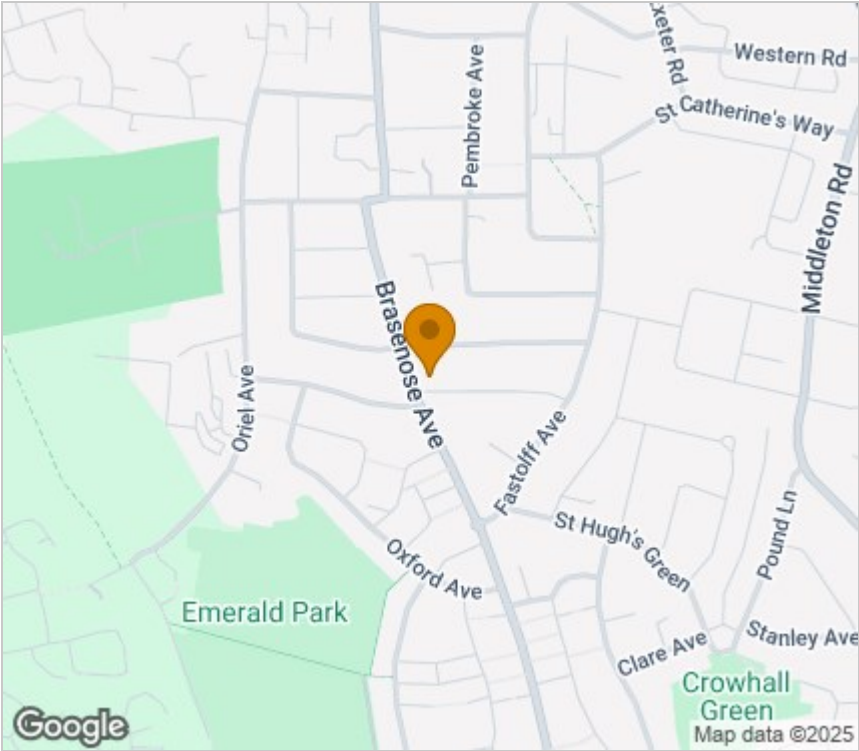

Energy Efficiency Graph

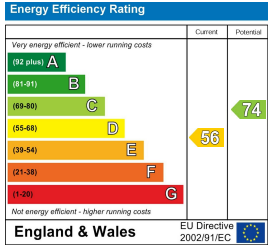

Viewing

Please contact our Aldreds Gorleston Office on 01493 664600 if you wish to arrange a viewing appointment for this property or require further information.

Disclaimer
These particulars are issued on an understanding that all negotiations shall be conducted through Messrs. Aldreds. Please note: Messrs. Aldreds for themselves and for the vendors or lessors of this property whose agents they are given notice that: 1. Particulars are set out as a general outline only for guidance of intending purchasers or lessees, and do not constitute nor constitute part of, an offer or contract. 2. All descriptions, dimensions, references to condition and necessary permissions for use and occupation, and other details are given without responsibility and any intending purchasers or tenants should not rely on them as statements or representations of fact but must satisfy themselves by inspection or otherwise as to the correctness of each of them. 3. No person in the employment of Messrs. Aldreds has any authority to make or give any representation or warranty whatever in relation to this property. 4. If you are proposing to visit the property and are travelling some distance please check with Aldreds on the issue of availability prior to travelling. 5. Aldreds Property Consultants and associated services may offer additional services to the prospective purchaser for which they will be entitled to receive a commission. Aldreds are pleased to be working with Mortgage Advice Bureau. They're an award-winning mortgage broker with over 1,400 advisers across the UK, and have access to over 12,000 mortgage products from over 90 lenders. Aldreds Estate Agents Ltd receive a commission of £200 on each completed case. Your home may be repossessed if you do not keep up repayments on your mortgage. There may be a fee for mortgage advice. The actual amount you pay will depend upon your circumstances. The fee is up to 1%, but a typical fee is 0.3% of the amount borrowed. Mortgage Advice Bureau is a trading name of Mortgage Seeker Limited which is an appointed representative of Mortgage Advice Bureau Limited and Mortgage Advice Bureau (Derby) Limited which are authorised and regulated by the Financial Conduct Authority. Mortgage Seeker Limited Registered Office: Lovewell Blake, Sixty Six North Quay, Great Yarmouth, Norfolk, NR30 1HE. Registered in England Number: 03721415. 6. Potential purchasers should check with their providers that the broadband and mobile phone coverage they would require is available.

149 High Street, Gorleston, Norfolk, NR31 6RB
Tel: 01493 664600 Email: gorleston@aldreds.co.uk <https://www.aldreds.co.uk/>
Registered in England Reg. No. 08945751 Registered Office: 17 Hall Quay, Great Yarmouth, Norfolk NR30 1HJ
Directors: Mark Duffield B.S.c. FRICS. Dan Crawley MNAEA Paul Lambert MNAEA